



MINI PISTOL GREASE GUNS

DELUXE

- Single-hand-operated pistol grip
- Die cast grease gun head with dual discharge ports for use with steel extension as well as flexible hose
- Develops 3500 PSI
- Capacity: 3 oz grease cartridge or bulk fill
- Textured zinc plated finish for non-slip grip
- Includes: 4" steel extension and professional 4-jaw coupler with ball check

Model No. AC477
Price/Each \$

aurora tools®



AC477

PISTOL GREASE GUNS

HEAVY-DUTY

- Designed for use in general confined spaces or where access to grease nipples is restricted
- Heavy-duty die cast grease gun head
- Develops 5000 PSI
- Capacity: 14 oz (400 g) grease cartridge or suction fill
- AC475 comes complete with 4" steel extension and 4-jaw coupler with ball check
- AC476 comes complete with 18" flexible hose and 4-jaw coupler with ball check

Model No. AC475

Price/Each \$

Model No. AC476

Price/Each \$

aurora tools®

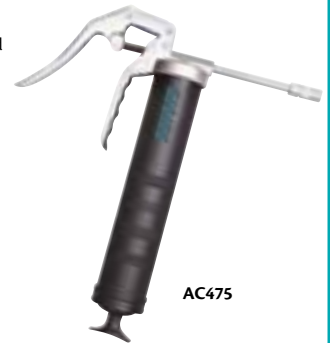

AC475

MINI GREASE GUNS

- Designed for use in general confined spaces, or where access to grease nipples is restricted
- Single-hand-operated push type grip
- Develops 1400 PSI
- Capacity: 3 oz. (85 g)

Model No. AD084

Price/Each \$

aurora tools®



AD084

AIR-OPERATED GREASE GUNS

- Ideal for use in factory maintenance
- Single shot of grease discharge with every press of the trigger
- Air operating range: 40 - 120 PSI
- Capacity: 14 oz. (400 g) grease cartridge or bulk fill
- Comes with 6" steel extension and professional 4-jaw coupler with ball check

Model No. AC478

Price/Each \$

aurora tools®



AC478

LEVER GREASE GUNS

STANDARD-DUTY

- Designed for use in general lubrication and daily maintenance work
- Capacity: 14 oz (400 g) grease cartridge or suction fill
- Complete with 6" steel extension and 4-jaw coupler with ball check
- Develops 6000 PSI

Model No. AC472

Price/Each \$

aurora tools®



AC472

HEAVY-DUTY

- Designed for punishing day-in and day-out heavy industrial application
- Built-in variable stroke feature for greasing fittings with limited access
- Die cast grease gun head fitted with bulk loader and air bleeder
- Extra heavy-duty zinc plated lever handle with ergonomic rubber grip
- Develops 10 000 PSI
- Capacity: 14 oz. (400 g) grease cartridge, filler pump or suction fill
- Includes: 6" steel extension and 4-jaw coupler with ball check

Model No. AC473

Price/Each \$

aurora tools®



AC473

SUCTION GUNS

- A rugged transfer gun designed for use with gear oils to get them both into and out of gear boxes, transfer cases and differentials
- Capacity: 16 oz
- Complete with 12" flexible vinyl hose

Model No. AC494

Price/Each \$

aurora tools®



AC494

FLEXIBLE GREASE HOSES

- Standard grease hose is the most popular version of flexible grease hoses
- AC481 hose fitted with heavy-duty spring guard adds safety and convenience in fitment, prevents those from bending
- Threads: 1/8" NPT
- Working Pressure 3500 PSI
- For hand-operated grease guns only

aurora tools®

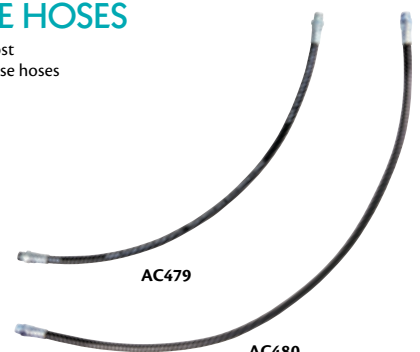

AC479

AC480

Model No.	Length" (End to End)	Price /Each
AC479	12	
AC480	18	
AC481	18	

PISTOL GRIP GREASE GUNS

PROFESSIONAL-DUTY

Develops 5500 PSI. Three-way loading: cartridge, suction or loader pump. Features automatic variable stroke/pressure, air vent, vinyl grip and loader fitting. Delivery: 1 oz. per 33 strokes.

Model No. AA690
Includes: rigid extension and coupler
Price/Each \$

Model No. AA691
Includes: 18" flexible hose and coupler
Price/Each \$



PNEUMATIC GREASE GUNS

Three way loading: cartridge, suction or loader pump. Features air vent, loader fitting, rigid extension and coupler.

Model No. AB821
Price/Each \$



LEVER GREASE GUNS

PROFESSIONAL-DUTY

Develops 10 000 PSI. Three-way loading: 14 oz. cartridge, suction or loader pump. Features automatic variable stroke/pressure, air vent, vinyl grip, loader fitting.

Delivery: 1 oz. per 21 strokes.

Model No. AA643
Includes: rigid extension and coupler
Price/Each \$

Model No. AB827
Includes: 18" hose and coupler
Price/Each \$

Model No. AB825
Includes: 24 oz. cylinder, rigid extension and coupler
Price/Each \$

AA643



SUCTION GUNS

16 oz. capacity. Includes flexible vinyl hose. Suitable for all purpose draining of non-corrosive lubricants.

Model No. AB833
Price/Each \$



HEAVY-DUTY/HIGH PRESSURE

Develops 10 000 PSI. Three-way loading: cartridge, suction or loader pump. Features heavy-duty lever with adjustable linkage for high pressure or high volume operation and loader fitting. Gun outlet 1/8" NPTF.

Delivery: 1 oz. per 16 strokes in high volume mode.

Delivery: 1 oz. per 25 strokes in high pressure mode.

Model No. AB817
16-oz. gun only
Price/Each \$

Model No. AA692
16-oz. gun with rigid extension and coupler
Price/Each \$

Model No. AB816
24-oz. gun with rigid extension and coupler
Price/Each \$

AA692



12 V CORDLESS GREASE GUNS

Lightweight, powerful, professional quality. The most innovative grease gun ever designed, giving you faster more efficient lubrication:

- High-Pressure Delivery: up to 6500 PSI
- High Flow Rate: 5.25 oz. per minute @ 1000 PSI
- 3-Way Loading: 14-oz. cartridge, 16-oz. bulk or suction loaded
- Lightweight: 6.8 lbs.
- Comes with two batteries

Model No. AB812
Price/Each \$



GREASE GUN EXTENSION HOSES

WARNING: For use with hand operated grease guns only.

- Economical and durable hose
- 12 000 PSI burst pressure
- 1/8" NPTF(M) ends



AA693

Model No.	Length"	Working Pressure	Hose Type	Price /Each
AA693	12	4800 PSI	Single Wire Braid	
AA694	18	4800 PSI	Single Wire Braid	

LUBRICATING EQUIPMENT

PROFESSIONAL COUPLERS

- Hardened spring steel jaws and hardened body withstands high pressure without deformation
- Hexagonal nut allows easy tightening
- Threads: 1/8" NPT
- 4-jaw construction, 6000 PSI
- For hand-operated grease gun only

Model No. AC482
Price/Each \$

aurora tools



HEAVY-DUTY COUPLERS

- Hardened spring steel jaws & hardened body with double wall thickness withstands very high pressure without deformation
- Hexagonal nut allows easy tightening
- Threads: 1/8" NPT
- 4-jaw construction, 10 000 PSI
- For hand and air operated equipment

Model No. AC483
Price/Each \$

aurora tools



HYDRAULIC COUPLERS - 360° SWIVEL

- Excellent coupler for effective lubrication of difficult and hard to reach grease fittings
- Swivels in full 360° circle and locks conveniently at any 45° position
- Spring loaded ball-check valve helps retain pressure
- Threads: 1/8" NPT
- 3-jaw construction, 7000 PSI

Model No. AC484
Price/Each \$

aurora tools



HYDRAULIC COUPLERS - RIGHT ANGLED

- Fits all standard grease gun
- Designed for right angled discharge of grease, very useful for greasing fittings with limited access or in low heights
- Threads: 1/8" NPT
- 10 000 PSI

Model No. AC485
Price/Each \$

aurora tools



SEAL-OFF DISPENSERS

- Used with grease gun extension or hose for lubricating grease plugs
- Threads: 1/8" NPT

Model No. AC491
Price/Each \$

aurora tools



STEEL BEARING PACKERS

- For use with grease guns
- The design incorporates a grease nipple at one end which easily adapts to the grease gun coupler
- Grease bearings in cars boats, RV, etc. with a minimum inner diameter of 1/2" to a maximum outer dia of 5" and height from 1/4" to 2"

Model No. AC493
Price/Each \$

aurora tools



GREASE GUN HOLDERS

- Simple snap action clamp for safe storage of grease guns and suction guns

Model No. AC486
Price/Each \$

aurora tools



GREASE INJECTOR NEEDLES

- Lubricates in very tight spaces such as universal joints and sealed bearings
- Equipped with standard grease fitting without ball check and protective plastic holder
- 18-gauge needle thickness
- 1 1/2" long

Model No. AC487
Price/Each \$

aurora tools



NEEDLE NOSE DISPENSERS

- Used for dispensing a fine line of grease
- Can be attached directly to steel extensions or flexible hoses
- Threads: 1/8" NPT
- AC490 has a narrow needle with a dia of 3.96 mm
- AC489 has a 5.56 mm needle dia

Model No.	Needle Length mm	Price /Each
AC489	15	
AC490	38	

aurora tools



NEEDLE NOSE ADAPTORS

- Used for dispensing a fine line of grease through the needle nose
- Tip diameter: 0.046" (1.168 mm)
- Needle length: 4"
- Quick connect action

Model No. AC488
Price/Each \$

aurora tools



EZEE-LUBE KITS

- The Ezee-Lube kit comprises of a range of quick-connect fittings designed to meet any and every greasing application lube accessories

Model No. AC492
Price/Each \$

aurora tools



aurora tools

OIL CANS

- Oil can body is seamless drawn from heavy-gauge tin coated sheet
- Premium powder coated finish

Model No.	Capacity oz.	Spout Length"	Spout Type	Pump	Price /Each
LEVER TYPE					
AC514	6	6	Flexible	Steel	
AC515	10	6	Flexible	Steel	
AC589	13	7	Flexible	Steel	
AC516	16	7	Flexible	Steel	
AC592	16	9	Flexible	Steel	
AC593	16	9	Rigid	Steel	
AC590	23	8	Flexible	Steel	
AC594	33	9	Flexible	Steel	
AC595	33	9	Rigid	Steel	
PISTOL TYPE					
AC588	4	5	Flexible	Steel	
AC513	6	5	Flexible	Steel	
AC597	6	6	Flexible	Steel	
AC596	6	6	Rigid	Steel	
AC599	16	6	Flexible	Steel	
AC598	16	6	Rigid	Steel	
AC600	33	6	Rigid	Steel	



HYDRAULIC GREASE COUPLERS

Provides quick, positive and leakproof connection with hydraulic fittings.

AA862



Model No.	Type	Thread	Max. Pressure PSI	Price /Each
QG997	Standard	1/8" NPTF(F)	10 000	
AB742*	Standard	1/8" NPTF(F)	10 000	
QF621	Narrow	1/8" NPTF(F)	10 000	
AA862*	Narrow	1/8" NPTF(F)	10 000	

*Equipped with built-in check valve

MANUAL LUBRICATION PUMPS

VOLUME DELIVERY BUCKET PUMPS

For all oils and pressure gun lubricants. Delivery 1/3 oz. per stroke. Will develop up to 500 PSI. Equipped with 25-lb capacity (5 gallons) container. Adjustable leverage adapts pump to lubricant and operating conditions. Pump outlet: 3/8" NPTF(F).

Model No. AA699
Price/Each \$



MULTI-PRESSURE BUCKET PUMPS

Variable pressure 2500 to 5000 PSI for 35-lb capacity (5 gallons). Adjustable leverage (three positions) adapts pump to all lubricant and operating conditions. Approximate delivery 1/3 oz. per stroke. Suitable for oil or grease. Hose length: 5'.

Coupler type: hydraulic (narrow). Includes hose assembly (Mfg. No. 322434)

Model No. AA698
Price/Each \$



PORTA-CARTS

- Used with AA699 and AA698 series pumps
- Speeds lubrication service where machines are widely separated
- Reduces operator fatigue
- Overall width: 18"

Model No. AA702
Price/Each \$

VOLUME DELIVERY LOADER PUMPS

- For grease guns with Alemite loader fitting
- Delivery: 1 lbs. per 6 strokes
- Includes loader extension and loader fitting
- For 35-lb pail
- Equipped with cover and flexible follower

Model No. AB814
Price/Each \$



DUAL LEVERAGE DISPENSERS

- For fluid gear lubricants
- Attach directly onto original containers
- Delivery: 1 pint per 6 strokes
- Pump outlet: 1/2" NPTF(F).
- For 5-gallon pail
- Includes: 5 1/2' hose with curved nozzle and pail cover

Model No. AB815
Price/Each \$



LUBRICATING EQUIPMENT

GREASE FILLER PUMPS

- An ideal grease filling solution to easily load bulk or combination grease guns from bulk grease pails
- Full economy in buying bulk grease
- Pail capacity: 5 gallons
- Rubber lining follower plate for use with most bucket types

Model No. AD383
Price/Each \$

aurora tools



BUCKET GREASERS

- High volume, high pressure grease pump
- Uses low cost bulk grease
- Delivers 3 g/stroke or 1 oz. in less than 10 strokes at pressures up to 2000 PSI
- Comes complete with 22-lb built-in steel grease bucket

Model No. AC495
Price/Each \$

aurora tools



AIR-OPERATED GREASE PUMPS

- Ideal for applications having continuous need for high pressure grease
- 50:1 ratio pump
- Recommended air pressure between 60 and 125 PSI
- Air inlet: 1/4" NPT (female)
- Grease outlet: 1/4" NPT (female)
- Fits 5-gallon and 16-gallon pails
- Comes complete with drum cover, rubber-lined follower plate, 7' of high pressure grease hose, Z swivel and grease control valve

Model No. AC496 For 25-50-lb. pails
Price/Each \$

Model No. AC497 For 120-lb. pail
Price/Each \$

aurora tools



SWIVELS

- Installed between the delivery hose and grease control valve, swivels permit easy handling of control valves and prevent damage to hose caused by twisting
- 6000 PSI

aurora tools

Model No.	Thread Specifications	Price /Each
AC499	1/4" NPT (F) - 1/8" NPT (M)	
AC500	1/4" NPT (F) - 1/4" NPT (M)	



GREASE CONTROL VALVES

- Premium quality
- For use with power-operated equipment
- Provides continuous grease flow with trigger fully depressed
- Inlet thread specification: 1/4" NPT (female)
- Outlet thread specification: 1/8" NPT (female)
- 7500 PSI
- Comes complete with 6" steel extension and heavy-duty coupler

Model No. AC498
Price/Each \$

aurora tools



EASY-OUT TOOLS

- Handy, dual-purpose tool for removing worn and broken grease fittings, as well as retapping holes for installing new grease fittings

aurora tools

Model No.	Tap Rethreads	Price /Each
AC511	1/4"-28	
AC512	1/8"-27	



GREASE FITTINGS

- Manufactured to the most stringent quality standards
- QS 9000 approved
- 10 fittings per package



SAE

Priced per Package

Model No.	Description	Price /Each
1/4" - 28 SAE-LT PIPE THREADS		
AC501	Short - Straight	
AC502	Short - 45°	
AC503	Short - 90°	
1/8" - 27 PIPE THREADS		
AC504	Short - Straight	
AC505	Short - 45°	
AC506	Short - 90°	
DRIVE FITTING		
AC507	For 3/16" Drill	

METRIC

Priced per Package

Model No.	Description	Price /Each
M6 X 1 PIPE THREADS		
AD202	Straight	4.67
AD203	90°	8.24
M8 X 1 PIPE THREADS		
AD204	Straight	5.46
AD205	90°	15.12
M10 X 1 PIPE THREADS		
AD206	Straight	5.46
AD207	90°	15.12

SETS

Model No.	Description	Contains	Price /Each
AC509	80 Pcs of SAE Grease Fittings	15 Pcs of 1/4" 28 SAE LT Straight 10 Pcs of 1/4" 28 SAE LT 45° Angle 10 Pcs of 1/4" 28 SAE LT 90° Angle 25 Pcs of 1/8" 27 NPT Straight 10 Pcs of 1/8" 27 NPT 45° Angle 10 Pcs of 1/8" 27 NPT 90° Angle	
AC510	80 Pcs of Metric Grease Fittings	20 Pcs of M6 x 1 Straight 10 Pcs of M6 x 1 90° Angle 15 Pcs of M8 x 1 Straight 10 Pcs of M8 x 1 90° Angle 15 Pcs of M10 x 1 Straight 10 Pcs of M10 x 1 90° Angle	

aurora tools



VEHICLE FITTING ASSORTMENTS

- Box contains six types of popular fittings
- An identifying chart is included in the cover



AA720

ASSORTMENT INCLUDES:

Model No.	Type	Thread	Quantity
AA677	Str.	1/8" P.T.F.	24
AA686	45°	1/8" P.T.F.	12
AA680	90°	1/8" P.T.F.	12
AA684	Str.	1/4"-28 Taper	24
AA683	45°	1/4"-28 Taper	12
AA689	90°	1/4"-28 Taper	12

Model No. AA720 Price/Each \$

METRIC FITTING ASSORTMENTS

- Box contains six types of popular metric fittings
- An identifying chart is included in the cover
- Thread conforms to German Standard DIN 71412



AB820

ASSORTMENT INCLUDES:

Model No.	Type	Thread	Quantity
AB845	Str.	6	10
AB839	45°	6	6
AB840	90°	6	6
AB844	Str.	8	6
AB841	90°	8	6
AB842	Str.	10	10

Model No. AB820 Price/Each \$

POCKET PACK FITTING ASSORTMENTS

- Box contains six types of popular fittings
- An identifying chart is included in the cover



AB826

ASSORTMENT INCLUDES:

Model No.	Type	Thread	Quantity
AA677	Str.	1/8" PTF	12
AA686	45°	1/8" PTF	6
AA680	90°	1/8" PTF	6
AA684	Str.	1/4"-28 Taper	12
AA683	45°	1/4"-28 Taper	6
AA689	90°	1/4"-28 Taper	6

Model No. AB826 Price/Each \$

LUBRICATION BULK FITTINGS 1/4" - 28 TAPER THREADS

- Used on most cars and trucks and on many industrial machines
- Features dirt excluding ball check
- Maximum pressure: 10 000 PSI

It is recommended that SAE-LT taper threads be assembled into 1/4" - 28 UNF, Class 3B, straight threaded holes having a modified maximum minor diameter of 0.2151" to insure 75% minimum thread height.

SAE-LT - conforms to Society of Automotive Engineers Lubrication thread specification.



1/8" PIPE THREADS

- Used on many industrial machines and heavy equipment
- Features dirt excluding ball check
- Maximum pressure: 10 000 PSI

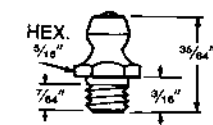

AA684

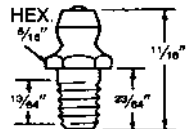

AA685

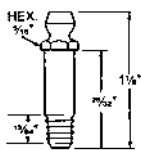

AA497

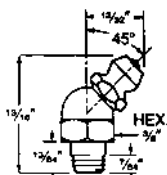

AA683

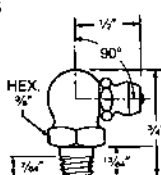

AA689

Model No.	Mfg. No.	Type	Overall Length"	Shank Length"	Hex Size"	Price /Each
AA684	1641-B	Str.	35/64	3/16	5/16	
AA685	1652-B	Str.	11/16	23/64	5/16	
AA497	1698-B	Str.	1 1/8	25/32	5/16	
AA683	1637-B1	45°	13/16	13/64	3/8	
AA689	1911-B1	90°	3/4	13/64	3/8	

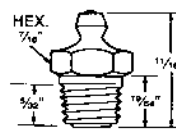

AA677

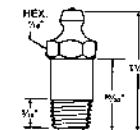

AA676

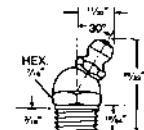

AA678

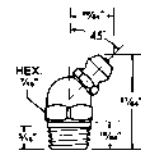

AA686

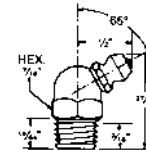

AA679

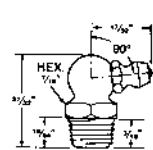

AA680

Model No.	Mfg. No.	Type	Overall Length"	Shank Length"	Hex Size"	Price /Each
AA677	1610-BL	Str.	11/16	19/64	7/16	
AA676	1607-B	Str.	1 1/4	25/32	7/16	
AA678	1611-B	30°	29/32	19/64	7/16	
AA686	1688-B	45°	57/64	19/64	7/16	
AA679	1612-B	65°	27/32	19/64	7/16	
AA680	1613-B	90°	27/32	19/64	7/16	

DRIVE FITTINGS

- Used extensively to avoid tapping costs in a wide variety of applications
- Alemite serrated shank grips securely and simplifies the replacement of damaged fittings in old or oversized holes
- Recommended only for low and medium pressures

IMPORTANT

Actual drill sizes cannot be shown because drilling varies with hardness of metal. Drill sizes indicated on drawings are merely a guide. Exact drill size can only be determined by sample drilling of the actual metal. When drilled to proper tolerance, the serrated edge of the fitting will provide a secure, lasting grip.

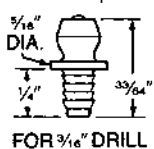

AA687

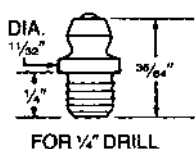

AA688

Model No.	Mfg. No.	Type	Overall Length"	Shank Length"	Drill Dia."	Price /Each
AA687	1728-B	Str.	33/64	1/4	3/16	
AA688	1743-B	Str.	35/64	1/4	1/4	

1/4" PIPE THREADS

- Widely used for larger bearings on farm machinery and heavy industrial equipment
- Recommended for heavy lubricants in cold weather
- Features dirt excluding ball check
- Maximum pressure: 10 000 PSI

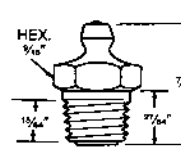

AA681

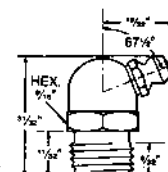

AA682

Model No.	Mfg. No.	Type	Overall Length"	Shank Length"	Hex Size"	Price /Each
AA681	1627-B	Str.	7/8	27/64	9/16	
AA682	1629-B	67 1/2°	31/32	11/32	9/16	